

# BECI Field Report

600 University Office Blvd., Bldg. 1, Suite 1A  
Pensacola, FL, 32504  
850.912.9990 Office



## PROJECT:

**Perdido Sun**  
13753 Perdido Key Dr.  
Pensacola, FL 32507

FIELD REPORT NO: **PRDDSN007**

CONSULTANTS PROJECT NO: **P140741899**

## SITE VISIT DATA

SITE VISIT DATE: **11/5/2024**

TIME: **08:00 AM**

WEATHER: **78°F, Rain & Windy**

## PRESENT DURING OBSERVATION:

Melanie Johnson - BECI  
Brian Jackson - C/Sharpe  
GSA Representatives

## WORK IN PROGRESS:

None.  
Conversation regarding storefront window mock-up.

## GENERAL OBSERVATIONS:



### Site Plan & Figure Legend

- Elevations Observed:
- Roof Areas Observed:
- Observations:
- Work in Progress:
- Exceptions:

## GENERAL OBSERVATIONS CONTINUED:

- 7.1 Melanie Johnson, with BECI, arrived onsite at 8:00 AM. The primary purpose of this site visit was to observe work in progress conditions related to the building enclosure and to report on compliance with plans, specifications, and industry standards. We discussed the ongoing work with the site team and focused our attention on discussion and details around the storefront window installation mock-up. A summary of our observations is as follows:
- 7.2 In the Ground Floor Lobby, we observed that the existing storefront window had been removed (Reference Figure 1). At the head of the rough opening, wooden bucking was existing with a concrete slab at the sill. The existing exterior stucco was slightly raised above the concrete slab and it was discussed that C/Sharpe would cut the stucco flush with the concrete slab. The FastFlash, Fluid-Applied Flashing and Waterproofing, would be applied at the rough opening, extending onto the cut portion of stucco. Additionally, we noted that plywood had been installed on the exterior side of the storefront window removal to protect the interior during replacement (Reference Figure 2). The team discussed the sill waterproofing detail and discussed that per the EFCO installation instructions, the two (2) exterior sides of the sill pan would be embedded in sealant. To avoid sealing up the weep holes, the exterior sealant joint would be installed from the metal flashing to the bottom lip of the frame. BECI drew a detail in the field to represent the new waterproofing directives for the sill of the new storefront window (Reference Figure 3).



**FIGURE 1 - Ground Floor Lobby - View of existing storefront window removed - Work in Progress.**



**FIGURE 2 - Ground Floor Lobby - View of plywood installed at exterior side of existing storefront window removal - Work in Progress.**

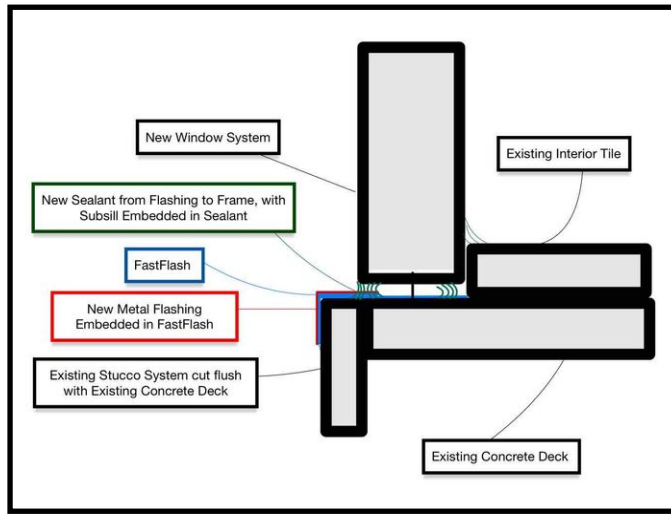

**FIGURE 3 - BECI Detail drawn on-site for new EFCO Storefront Window Waterproofing.**

## ACTION LIST:

The following is a list of **ACTION ITEMS** that resulted from Site Visits and Meeting with those present during our observations. Information contained below will serve as the responsible parties' notice of issues and the issues will be considered unresolved until removed from the table below in future field reports. The items are noted by the paragraph number of the report in which they were noted. If any party has disputes, changes or additions, please email [dlewis@be-ci.com](mailto:dlewis@be-ci.com)

ITEM	DESCRIPTION	STATUS & ACTION TAKEN	RESOLUTION
------	-------------	-----------------------	------------

## PROGRESS PHOTOS:

The attached photographs indicate the progress of the project on Tuesday, November 5, 2024:



**Photo 1**

Ground Floor Lobby - View of existing storefront window removed - Work in Progress.



**Photo 2**

Ground Floor Lobby - View of existing storefront window removed - Work in Progress.



**Photo 3**

Ground Floor Lobby - View of plywood installed at exterior side of existing storefront window removal - Work in Progress.



**Photo 4**

Ground Floor Lobby - View of plywood installed at exterior side of existing storefront window removal - Work in Progress.

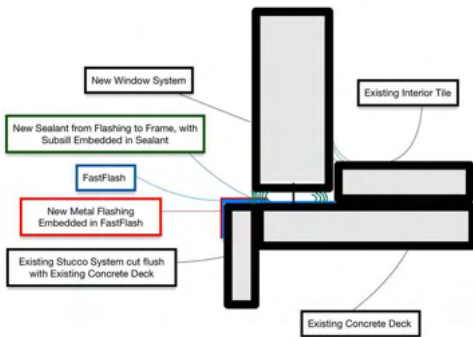

**Photo 5**

BECI Detail drawn on-site for new EFCO Storefront Window Waterproofing.

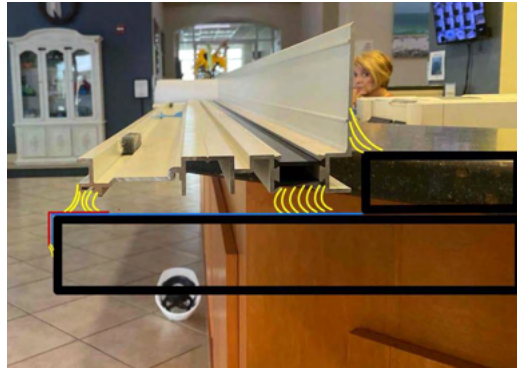

**Photo 6**

BECI Detail drawn on-site for new EFCO Storefront Window Waterproofing.

**BECI REPORT BY:**

*Melanie Johnson*

---

Melanie Johnson  
Project Engineer I

*Derek Lewis*

---

Derek Lewis  
Branch Manager